

RESIDENCE  
**04A**  
LEVELS 9-15



**COME HOME TO MR. C**



**Mr.C**  
**RESIDENCES**  
WEST PALM BEACH, FL

BY  
IGNAZIO  
AND  
MAGGIO  
CIPRIANI

**Exclusive Sales and Marketing by Douglas Elliman Development Marketing**

This project is being developed by Lakeview Hospitality Investments, LLC, a Delaware limited partnership ("Developer"), which has a limited right to use the trademarked names and logos of Mr. C, Terra, Sympatico Real Estate and which uses the Mr. C marks under a license from Mr. C, which has not confirmed the accuracy of any of the statements or representations made about the project by the Developer. Any and all statements, disclosures and/or representations shall be deemed made by Developer, and you agree to look solely to Developer with respect to any and all matters relating to the sales and marketing and/or development of the project. ORAL REPRESENTATIONS CANNOT BE RELIED UPON AS CORRECTLY STATING THE REPRESENTATIONS OF THE DEVELOPER. FOR CORRECT REPRESENTATIONS, MAKE REFERENCE TO THIS BROCHURE AND TO THE DOCUMENTS REQUIRED BY SECTION 718.503, FLORIDA STATUTES, TO BE FURNISHED BY A DEVELOPER TO A BUYER OR LESSEE. These materials are not intended to be an offer to sell, or solicitation to buy a unit in the condominium. Such an offering shall only be made pursuant to the prospectus (offering circular) for the condominium and no statements should be relied upon unless made in the prospectus or in the applicable purchase agreement. WARNING: THE CALIFORNIA DEPARTMENT OF REAL ESTATE HAS NOT INSPECTED, EXAMINED, OR QUALIFIED THIS OFFERING. These materials are not intended to be an offer to sell, or solicitation to buy a unit in either of the condominiums described herein. Such an offering shall only be made pursuant to the prospectus (offering circular) for the applicable condominium and no statements should be relied upon unless made in the applicable prospectus or in the applicable purchase agreement. In no event shall any solicitation, offer or sale of a unit in the applicable condominium be made in, or to residents of, any state or country in which such activity would be unlawful. Stated square footages and dimensions are measured to the exterior boundaries of the exterior walls and the centerline of interior demising walls and in fact vary from the square footage and dimensions that would be determined by using the description and definition of the "Unit" set forth in the Declaration (which generally only includes the interior airspace between the perimeter walls and excludes all interior structural components and other common elements). This method is generally used in sales materials and is provided to allow a prospective buyer to compare the Units with units in other condominium projects that utilize the same method. Measurements of rooms set forth on this floor plan are generally taken at the farthest points of each given room (as if the room were a perfect rectangle), without regard for any cutouts or variations. Accordingly, the area of the actual room will typically be smaller than the product obtained by multiplying the stated length and width. All dimensions are estimates which will vary with actual construction, and all floor plans, specifications and other development plans are subject to change and will not necessarily accurately reflect the final plans and specifications for the development. All depictions of furniture, appliances, counters, soffits, floor coverings and other matters of detail, including, without limitation, items of finish and decoration, are conceptual only and are not necessarily included in each residence. Furnishings are only included if and to the extent provided in your purchase agreement. The project graphics, renderings and text provided herein are copyrighted works owned by the Developer. All rights reserved. Unauthorized reproduction, display or other dissemination of such materials is strictly prohibited and constitutes copyright infringement. No real estate broker is authorized to make any representations or other statements regarding the project, and no agreements with, deposits paid to or other arrangements made with any real estate broker are or shall be binding on the Developer. Equal housing opportunity.

RESIDENCE  
**04A**

LEVEL 9-15

**2 Bedrooms**  
**2.5 Bathrooms**

INTERIOR: 1170 SQ. FT. 109 SQ. M.  
 BALCONY: 230 SQ. FT. 21 SQ. M.  
 TOTAL: 1400 SQ. FT. 130 SQ. M.

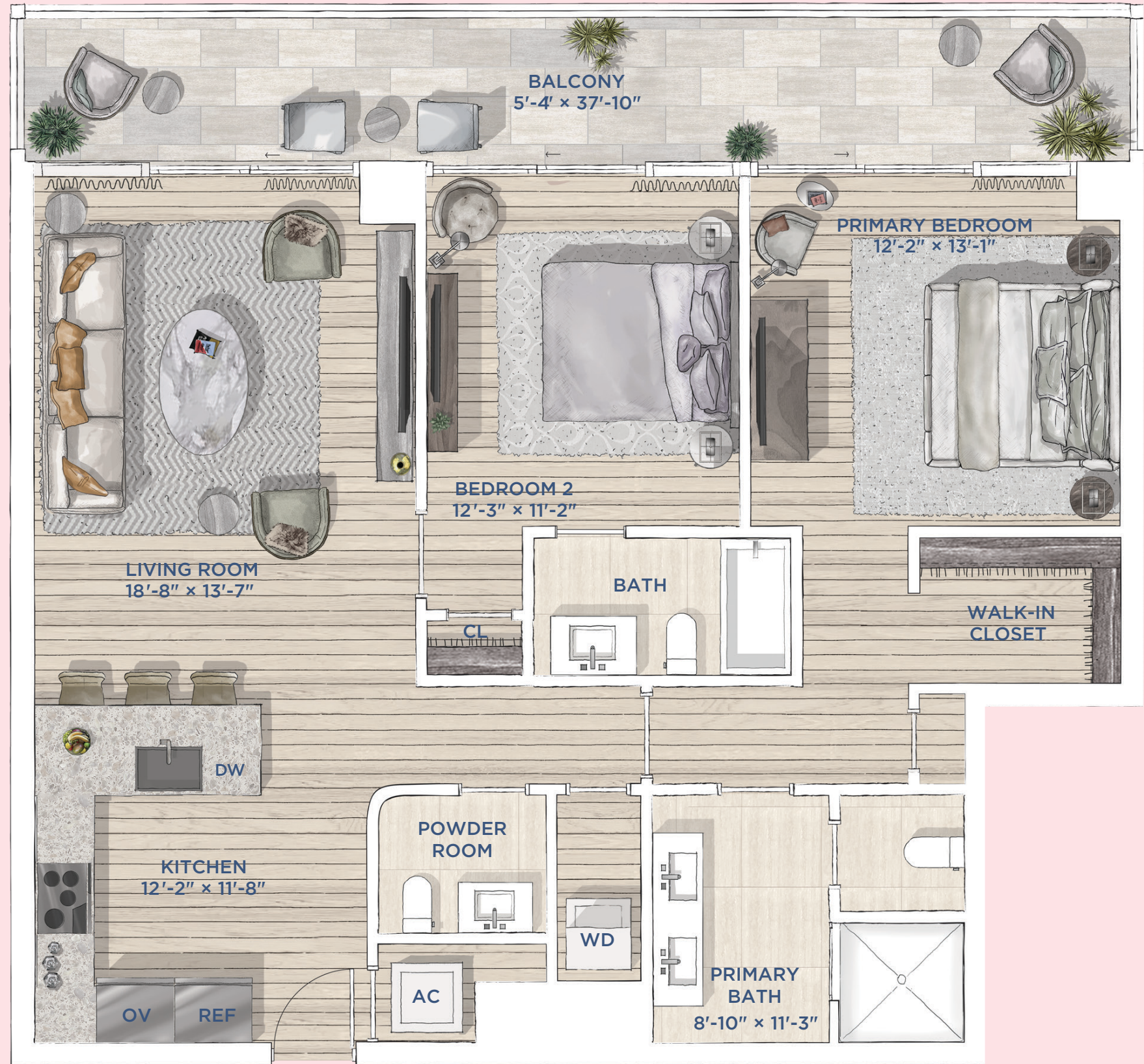
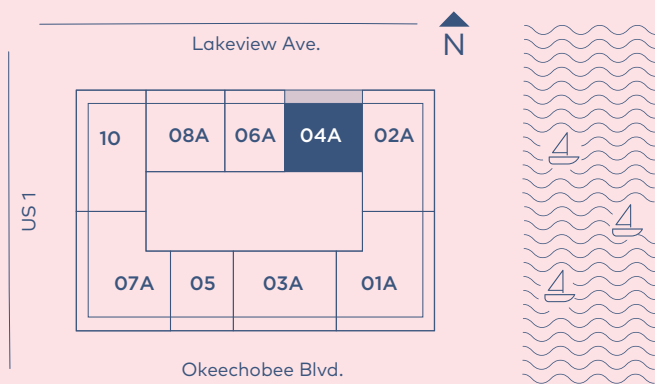

Exclusive Sales and Marketing by Douglas Elliman Development Marketing  
 Stated square footages and dimensions are measured to the exterior walls and the centerline of interior demising walls and in fact vary from the square footage and dimensions that would be determined by using the description and definition of the "Unit" set forth in the Declaration (which generally only includes the interior airspace between the perimeter walls and excludes all interior structural components and other common elements). This method is generally used in sales materials and is provided to allow a prospective buyer to compare the Units with units in other condominium projects that utilize the same method. Measurements of rooms set forth on this floor plan are generally taken at the farthest points of each given room (as if the room were a perfect rectangle), without regard for any cutouts or variations. Accordingly, the area of the actual room will typically be smaller than the product obtained by multiplying the stated length and width. All dimensions are estimates which will vary with actual construction, and all floor plans, specifications and other development plans are subject to change and will not necessarily accurately reflect the final plans and specifications for the development.